

GEC KINGSWAY SELF CHECK-IN INSTRUCTIONS

1. Upon arrival at GEC Kingsway residence entrance



2. Use buzzer "1111" or "2222"



3. Inform us that you are here to check in and provide us with your registered name

4. Enter the residence, and find the key pick up locker on your right

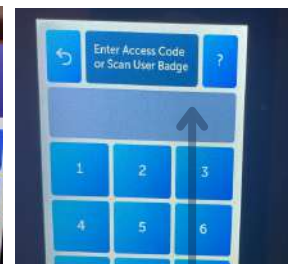
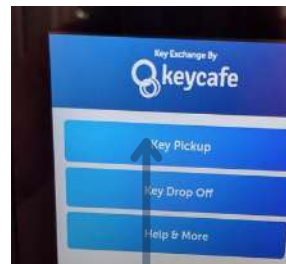
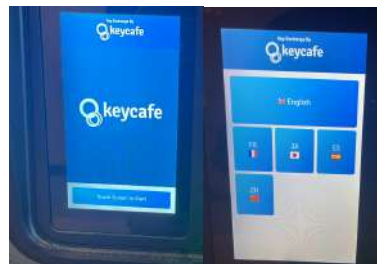

5. Touch to start, and choose the language

6. Select "Key Pickup"

7. Enter the access code provided by our caretaker or leasing team

8. Get your key from one of the slots. Please remember to close the slot right after



GEC KINGSWAY RESIDENCE HANDBOOK

GENERAL INFORMATION

Your mailing Address:

Your name & unit number

4589 Gladstone St, Vancouver BC
V5N 0H6

Check-in Time:

from 4 pm

Check-out Time:

before 11 am

CONTACT INFORMATION

Leasing office (Mon to Fri, 9 am to 5 pm)

604 669 6686 | reservations@gecliving.com

Caretaker (Sun to Thu, 9 am to 5 pm)

778 682 0120 | kingsway@gecliving.com

After-hours Emergency Line

778 682 1311

RENT PAYMENT

Rent is due on the 1st day of each month. Late rent payments may be fined up to \$25.

MAINTENANCE SERVICES

For both rent payment and maintenance services, please use the link below:

<https://gecliving.com/maintenance-request-rentpayment/>

SECURITY FOB

Your fob is programmed for access to your unit/floor and the following:

