

GEC KING EDWARD SELF CHECK-IN INSTRUCTIONS

1. Upon arrival at GEC King Edward residence entrance



2. Use buzzer "1111" or "2222" or "3333"



3. Inform us that you are here to check in and provide us with your registered name

4. Enter the residence, and find the key pick up locker on your left

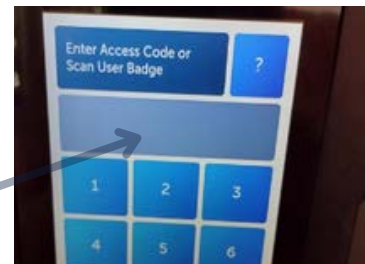
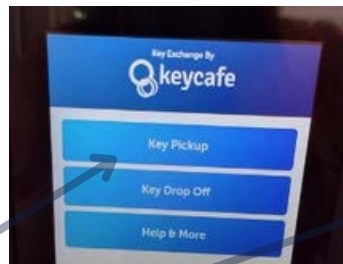

5. Select "Key Pickup"

6. Enter the access code provided by our caretaker or leasing team

7. Get your key from one of the slots. Please remember to close the slot right after

*Units 433, 435, 437, 439, 441, 443, 451, 453, 455, and 457 are located at the back of the building. Please take the walkway on the side to reach your units.

